



Roofing

support

...from concept to construction



Sarnafil®



Industry leading support – an intrinsic part of every Sarnafil roof

A key component of every Sarnafil roof is the carefully integrated package of services that initially enabled its installation and subsequently provides life-cycle customer support and industry leading guarantees.

Sarnafil – more than a system: a philosophy

Sarnafil roofing systems provide an almost infinite range of design possibilities, with an unparalleled range of components and options to suit virtually any kind of new roof or refurbishment project.

We believe that the carefully developed process behind every Sarnafil roof, as well as our product capability, is what sets us apart from our competitors.

We have spent many years developing and refining the Sarnafil Quality Management System (QMS) scheme, to provide a 'road map' for working practices throughout our company and within our partner companies.

Control means consistent quality

The key players behind every Sarnafil roof, are professionally trained to specified standards. This applies not only to our own Managers, Technical Advisers and Field Technicians, but also to each and every Sarnafil installer working for our

Registered Contractors. Sarnafil roofs can only be installed by these selected companies, to ensure that the Sarnafil QMS is adhered to throughout the process.

Progression through the Sarnafil QMS involves a number of checking stages to achieve specific 'milestones', prior to the issue of a guarantee, as listed below:

- Initial concept
- Specification and design
- Order and logistics
- Installation
- Completion inspection
- Guarantee issue

Technical support for specifiers

As the leader in single-ply roofing systems, we are committed to fostering best practice amongst architects and specifiers.

Through our experienced Technical Advisers, we offer design and specification support as well as a programme of comprehensive CPD seminars.



Industry leading support – an intrinsic part of every Sarnafil roof	2
Concept and design support	4
Logistics and installation	6
Inspection and guarantees	8
Guarantees coverage guide	10

Checking stages within our Quality Management System



Sarnafil installers are trained by our Applications Department: the same team which checks designs and specifications on site and carries out final inspections.

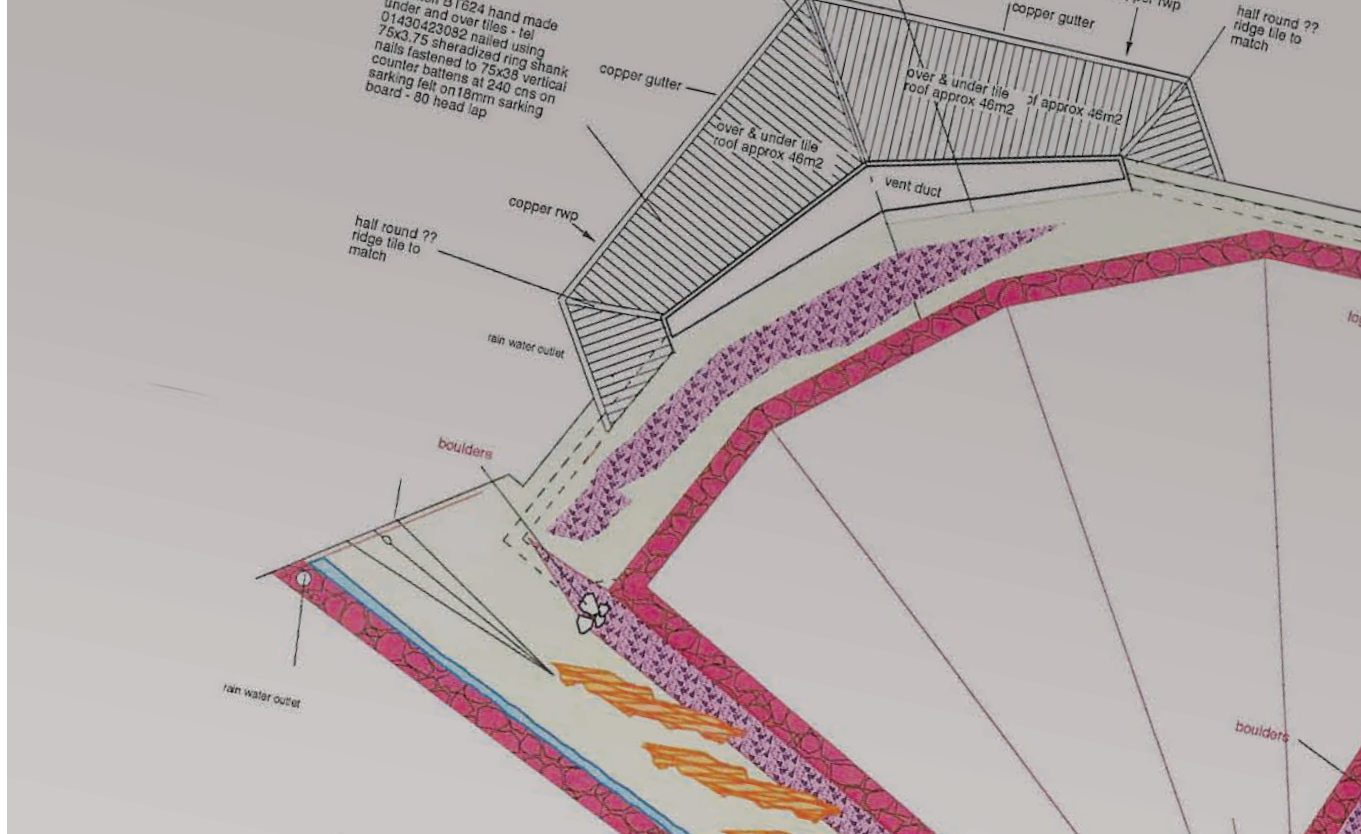

Right from the start – Sarnafil concept and design support

Specifiers and designers can draw on the vast bank of experience provided by our nationwide team of Sarnafil Technical Advisers. Their application knowledge of single-ply systems is respected throughout the industry.

The concept stage

Following consultation with the specifier, the Sarnafil Technical Adviser provides design assistance and technical advice, followed by a detailed written specification. They will carry out site visits and/or meetings at customer premises to ensure the project gets off to the right start.

All Sarnafil Technical Advisers are experienced roofing industry professionals who have undertaken appropriate training covering Sarnafil systems. They can advise on concepts and feasibility; system specification; compliance with Building Regulations; detailing; on-site considerations and planning.

Design support

Behind the scenes, our Technical Services Department brings immense technical and application knowledge to every Sarnafil project. This department checks and validates specifications and provides wind uplift calculations using bespoke, specialist software. These calculations

ultimately form part of the information upon which our Guarantee is based: an approach that is unique to Sarnafil within our industry.

Drainage calculations using Sarnafil rainwater outlets can also be provided if required.

Later in the project, the Technical Services Department also checks material orders against the original specification and provides telephone, fax and e-mail technical support to specifiers and contractors.

CPD seminars

Our range of RIBA accredited and non-accredited CPD seminars support specifiers, contractors and clients in understanding the issues surrounding the specification of single ply roofing.

Tailor-made seminars and training can also be arranged at clients' premises if required.



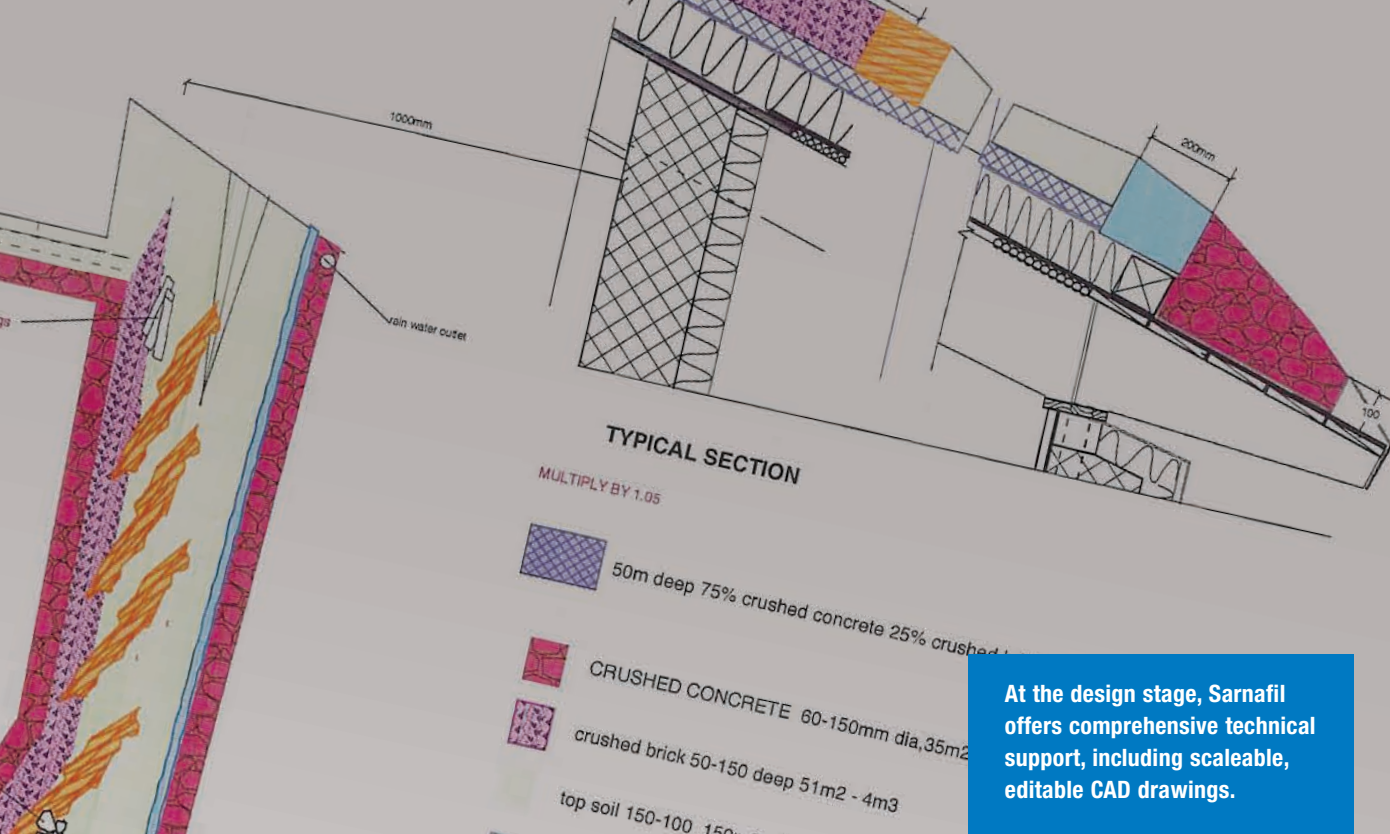



Logistics and installation – delivering the promise

Once the specification has been finalised, our Order and Logistics Department takes the central role, liaising with the Sarnafil Registered Contractor who will carry out the installation.

Order and logistics

Our Order and Logistics Department schedules material stocks and co-ordinates deliveries to site.

The Department maintains close contact with Sarnafil Registered Contractors and third party logistics providers, to ensure that project schedules are maintained and customer expectations are met.

Installation & installer training

Installation of Sarnafil Roofs can only be carried out by Sarnafil trained and registered contractors. Each of these companies is a roofing specialist and works in partnership with us to deliver the completed roof.

Installers employed by Sarnafil Registered Contractors each have to carry out hands-on training at our Training Centre. Here they are able to hone their skills under expert supervision from our Applications Department – the same team that will inspect their work on site, prior to guarantee issue.

Facilities at the Training Centre allow installers to carry out simulated installations, with particular focus on detailing around roof features. This close attention to detail pays dividends at the final installation stage and ensures adherence to specified standards and working practices.



On large roof areas, Sarnafil roofing membranes can be welded using our 'Sarnamatic' automatic welding machine, which achieves a high quality result in a fraction of the time taken by hand welding.



Correctly applied Sarnafil welds are stronger than the surrounding membrane. Our installer training pays particular attention to detailing around roof features.



Site deliveries are scheduled by our Order and Logistics Department.

Sarnafil®



Inspection and guarantees – completing the quality process

Sarnafil roofing systems set the standard for quality and longevity in single-ply roofing. Our guarantees reflect this – no other roofing manufacturer offers a comparable choice or level of protection against failure.

Inspection

Once the project is on site, a Field Technician will conduct an interim inspection of the work during the project. All Sarnafil roofing projects have a dedicated Field Technician who joins the project team and carries out inspections at agreed key stages of the project.

On completion of the roofing system, the Field Technician carries out a Final Inspection, ensuring that the work has been carried out in accordance with the specification and that it meets the necessary standards for guarantee.

With such an important role for the satisfactory completion of the project, experience is crucial. This is why all of our Field Technicians are ex-single ply roofing installers with a minimum of 5 years experience. Together they form our Applications Department, the team responsible for training Sarnafil's Registered Contractors, checking ongoing work and inspecting projects for guarantee.

Guarantees

Sika has researched and developed its range of Sarnafil guarantees into a package of options that can provide the building owner with a unique level of comprehensive cover.

Drawing together experiences from our long roofing history and our comprehensive risk management system has enabled us to formulate clear, simple guarantee options, as follows:

The Sarnafil Extended Products

Guarantee can cover the entire roofing system from the top of the deck upwards and a combination of selected Sarnafil branded components to suit the project.

The Sarnafil Extended Products Guarantee provides this integrated approach through unique partnership agreements with major manufacturers in the construction industry, providing a single point of responsibility for the roofing system.





Our Field Technicians are all ex-roofing installers with a minimum of five years experience. This is the team responsible for carrying out the Sarnafil Final Inspection required before a guarantee can be issued.

The Sarnafil Product Guarantee

covers the primary waterproofing system including Sarnafil fasteners and adhesives. The Sarnafil Product Guarantee only covers those products sold directly by Sika.

Both options cover against damage by errors in our wind load calculation. The logic behind our guarantees is simple: when you buy a car you expect the manufacturer to guarantee the components included in its construction.

Full details of components covered and guarantee duration are covered overleaf on pages 10 & 11.



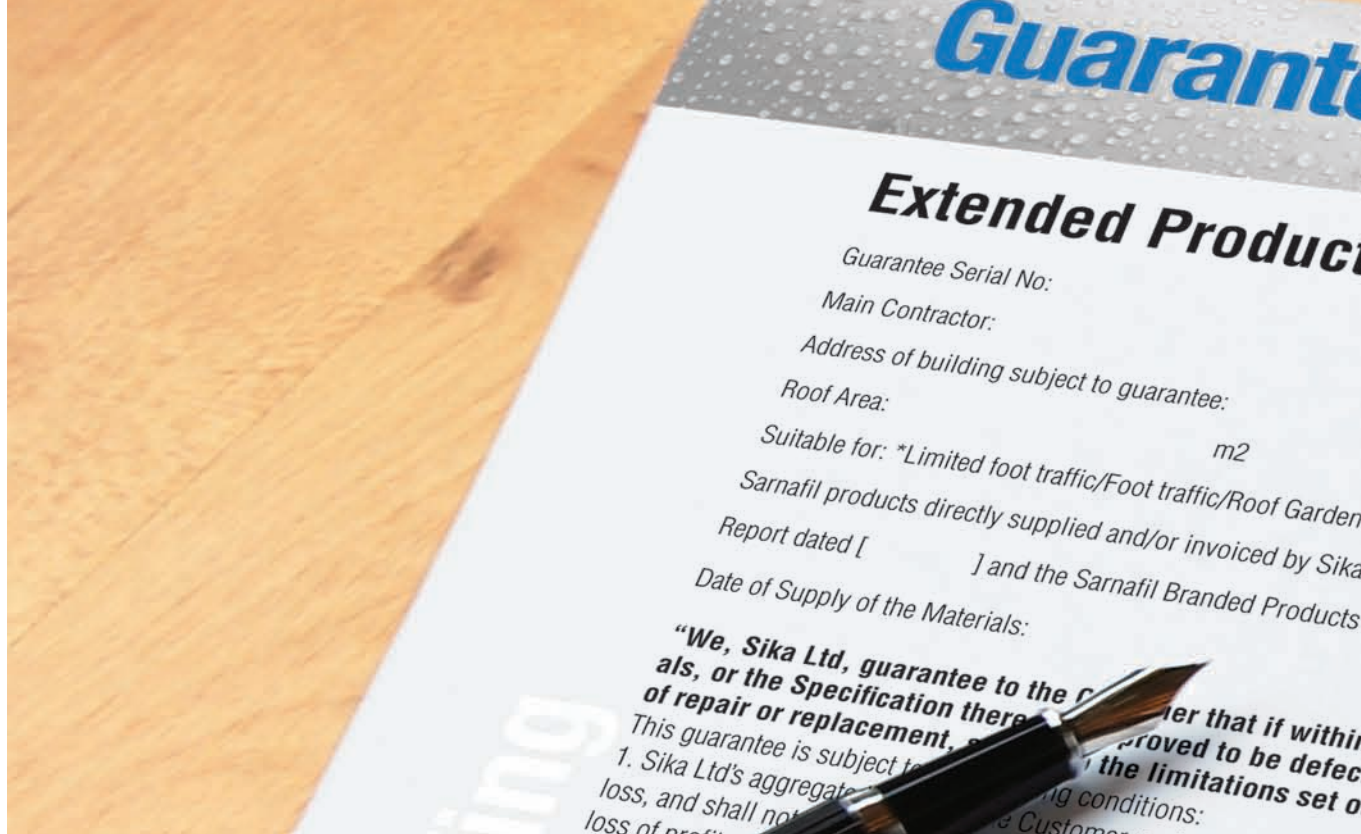

Sarnafil roofing guarantees – coverage guide

Sarnafil roofing guarantees can be tailored to meet specific requirements, in terms of components covered and duration of guarantee. This table outlines all the options.

Roofing System Components	Cover options		Duration of cover			
	Extended Products	Product	10 yr	15 yr	20 yr	25 yr*
Membrane: Sarnafil G/S/TCG/TCS	●	●	●	○	○	○
Metal Trims: Sarnametal	●	●	●	○	○	○
Sealant: Sarnaplast 2005/2235	●	●	●	-	-	-
Rainwater Outlets: Double L/SarnaDrain G/S & TG/TS	○	○	●	○	○	○
Rainwater Overflow chutes and scuppers	○	○	●	○	○	○
Gravity Drainage	○	-	●	○	○	○
Siphonic Drainage	○	-	●	○	○	○
Fasteners, Membrane: SBT/SFT	●	●	●	○	○	○
Fasteners, Insulation: SBT	●	●	●	○	○	○
Adhesive, Membrane: Sarnacol 2170/2142S	●	●	●	○	○	○
Adhesive, Insulation; Sarnacol 2162	●	●	●	○	○	○
Insulation, PIR: SarnaTherm	●	○	●	○	○	○
Insulation, EPS: SarnaTherm	○	-	●	○	○	○
Insulation, XPS: SarnaTherm	○	-	●	○	○	○
VCL, Polyethylene: Sarnavap 500 E/Sarnavap 1000E/Sarnavap 2000E	●	●	●	○	○	○
VCL, Al foil/Self adhered Sarnavap 5000E SA	●	●	●	○	○	○

* Please note that this is not available on all specifications.





Roofing System Components	Cover options		Duration of cover			
	Extended Products	Product	10 yr	15 yr	20 yr	25 yr*
Rooflights, Modular: SarnaLite	<input type="radio"/>	-	<input checked="" type="radio"/>	<input type="radio"/>	<input type="radio"/>	<input type="radio"/>
Rooflights, Continuous: SarnaLite	<input type="radio"/>	-	<input checked="" type="radio"/>	<input type="radio"/>	<input type="radio"/>	<input type="radio"/>
Rooflights, Custom: SarnaLite	<input type="radio"/>	-	<input checked="" type="radio"/>	<input type="radio"/>	<input type="radio"/>	<input type="radio"/>
Separation/cushion layers: SarnaFelt Type A, M, S,	<input checked="" type="radio"/>	<input checked="" type="radio"/>	<input checked="" type="radio"/>	<input type="radio"/>	<input type="radio"/>	<input type="radio"/>
Isolation layers: SarnaFelt Type T	<input checked="" type="radio"/>	<input checked="" type="radio"/>	<input checked="" type="radio"/>	<input type="radio"/>	<input type="radio"/>	<input type="radio"/>
Protection Sheet, G445/TG63	<input type="radio"/>	<input type="radio"/>	<input checked="" type="radio"/>	<input type="radio"/>	<input type="radio"/>	<input type="radio"/>
Walkway, SarnaTred	<input type="radio"/>	<input type="radio"/>	<input checked="" type="radio"/>	<input type="radio"/>	<input type="radio"/>	<input type="radio"/>
Aesthetic Decor/Batten Profile	<input type="radio"/>	<input type="radio"/>	<input checked="" type="radio"/>	<input type="radio"/>	<input type="radio"/>	<input type="radio"/>
Fall Arrest/Restraint: Sarnafil Constant Force post	<input type="radio"/>	-	<input checked="" type="radio"/>	<input type="radio"/>	<input type="radio"/>	<input type="radio"/>
Lightning Protection Clip	<input type="radio"/>	<input type="radio"/>	<input checked="" type="radio"/>	<input type="radio"/>	<input type="radio"/>	<input type="radio"/>
SarnaPad Paving Support	<input checked="" type="radio"/>	<input checked="" type="radio"/>	<input checked="" type="radio"/>	<input type="radio"/>	<input type="radio"/>	<input type="radio"/>
Insurance Cover						
Consequential Direct Loss Insurance	<input checked="" type="radio"/>	<input checked="" type="radio"/>	<input checked="" type="radio"/>	<input type="radio"/>	<input type="radio"/>	<input type="radio"/>
Specification Design Insurance	<input checked="" type="radio"/>	<input checked="" type="radio"/>	<input checked="" type="radio"/>	<input type="radio"/>	<input type="radio"/>	<input type="radio"/>
Inspection Design Insurance	<input type="radio"/>	<input type="radio"/>	<input type="radio"/>	<input type="radio"/>	<input type="radio"/>	<input type="radio"/>
Standard Details	<input checked="" type="radio"/>	<input checked="" type="radio"/>	<input checked="" type="radio"/>	<input type="radio"/>	<input type="radio"/>	<input type="radio"/>
Wind Uplift Design Insurance	<input checked="" type="radio"/>	<input checked="" type="radio"/>	<input checked="" type="radio"/>	<input type="radio"/>	<input type="radio"/>	<input type="radio"/>
Drainage Design Insurance	<input type="radio"/>	<input type="radio"/>	<input checked="" type="radio"/>	<input type="radio"/>	<input type="radio"/>	<input type="radio"/>

KEY: ● Standard cover ○ Optional ◐ Standard in certain system - Not applicable



Draw on our knowledge and expertise

We offer a comprehensive range of information and support resources for architects, contractors and other specifiers, including:

- Experienced Technical Advisers, who can help you to develop specifications
- Comprehensive technical literature
- Scalable, layered CAD detail drawings thermally modelled by the BRE available to download free online at www.sarnafil.co.uk

We are the complete single ply roofing specialist for:

- Surveys and site inspections
- Specification and design support
- New installations
- Refurbishment
- Solar roofing solutions
- CPD Seminars
- Installer training
- ISO 9000:2000 quality management system
- ISO 14001 environmental management system

The Single Ply Roofing Association (SPRA) represents membrane manufacturers, associated component manufacturers and specialist sub contractors and aims, through a quality assured partnership, to ensure the delivery of best value single ply roofing systems.

By specifying products and specialist installation by SPRA Manufacturer, Associate and Contractor members you can be assured that all parties meet strict quality criteria. Compliance with these criteria and with the Code of Conduct is assessed at application, by annual audit and by random spot checks.

For further information, and to obtain copies of the SPRA Design Guide and other documents, go to www.spra.co.uk or call 0115 914 4445.



For further information about Sarnafil products and our range of services, please call us on 01603 709360 or visit www.sarnafil.co.uk.

To the best of our knowledge all information contained in this brochure was correct at the time of issue. Printed on paper from sustainable forests.



Sika Limited
Bankside 300, Peachman Way, Broadland Business Park, Norwich, NR7 0WF
Telephone: 01603 709360 Fax: 01603 433436

Registered Office: Sika Limited, Watchmead, Welwyn Garden City, Hertfordshire, AL7 1BQ
Registered in England: Number 226822

Sarnafil®